

This USG System Detail must not be used without a complete evaluation by owner's design professional to verify the suitability of its use with your specific application.

## Construction Solution Details: Steel Beam with Offset

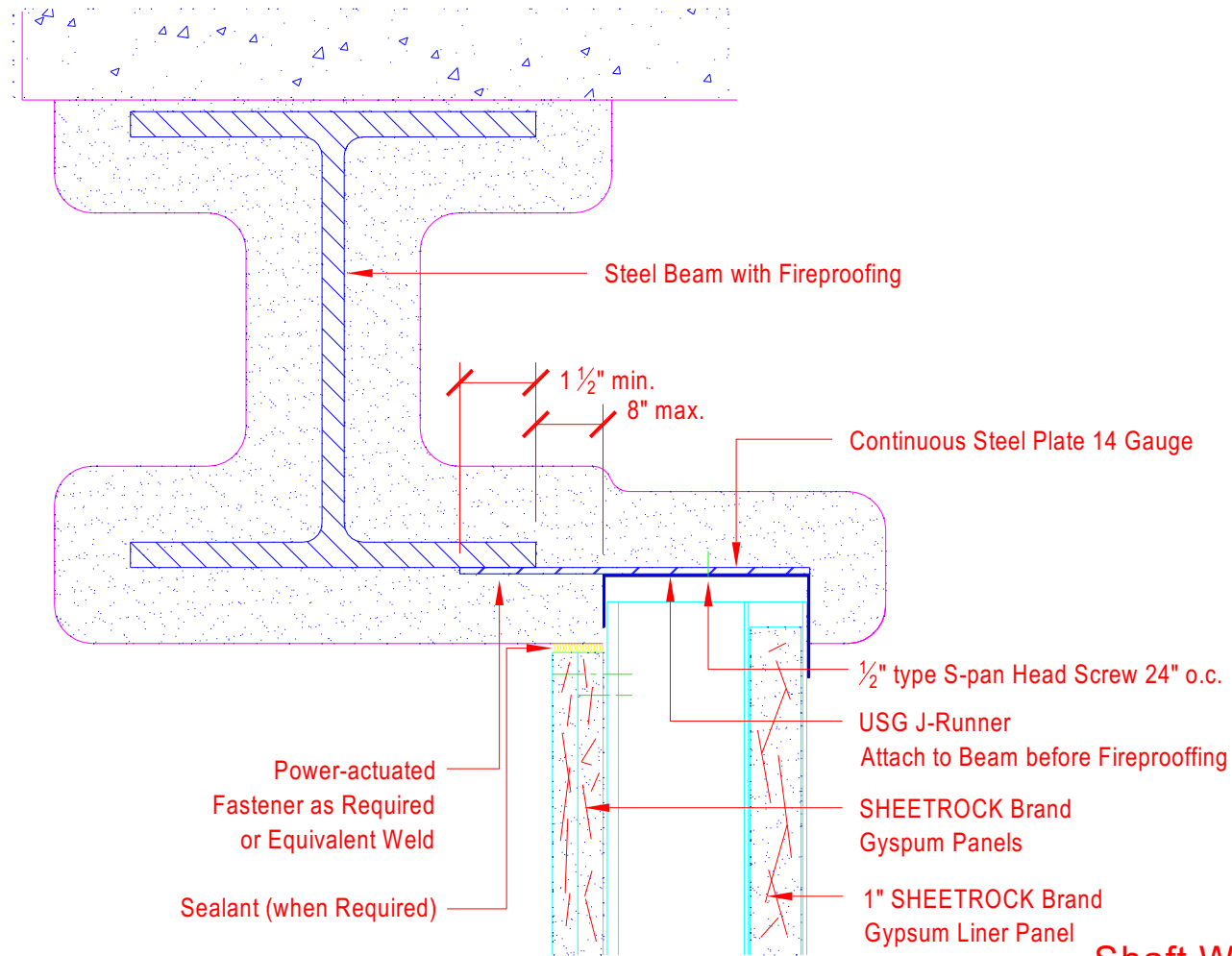

### Shaft Wall



USG Corporation  
125 South Franklin Street  
Chicago, IL 60606-4678

Architectural and Technical Solutions  
800-874-4968

Drawn by: N/A  
Approved: SM  
Revision: DN  
Scale: Not to Scale

Date: August 16, 2006  
Date:  
Change:  
Project:  
File: 093100036

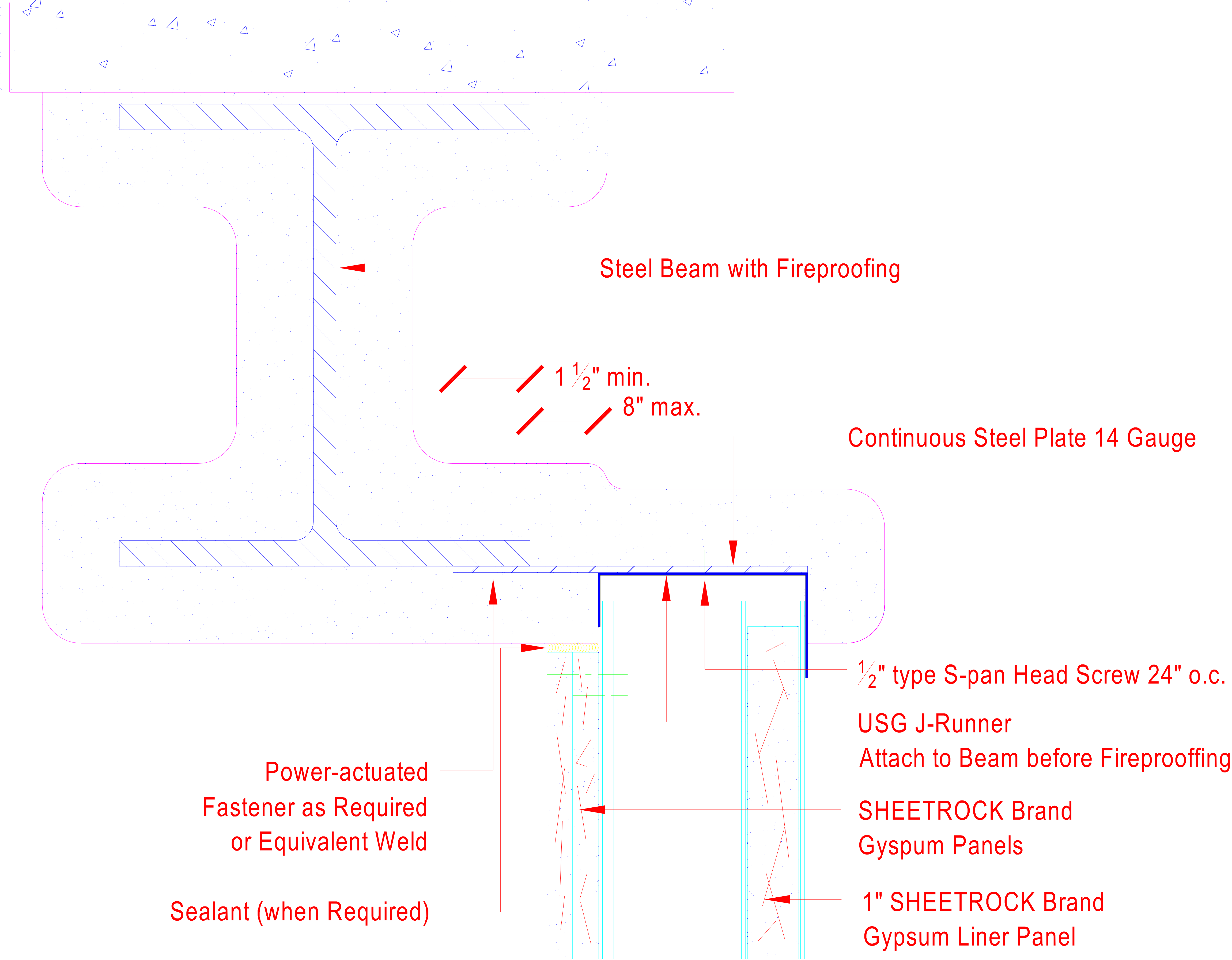

Steel Beam with Fireproofing

1 1/2" min.  
8" max.

Continuous Steel Plate 14 Gauge

1/2" type S-pan Head Screw 24" o.c.

USG J-Runner  
Attach to Beam before Fireproofing

SHEETROCK Brand  
Gypsum Panels

1" SHEETROCK Brand  
Gypsum Liner Panel

Power-actuated  
Fastener as Required  
or Equivalent Weld

Sealant (when Required)