

This USG System Detail must not be used without a complete evaluation by owner's design professional to verify the suitability of its use with your specific application.

## Construction Solution Details: Elevator Door Rough Opening Section A-A

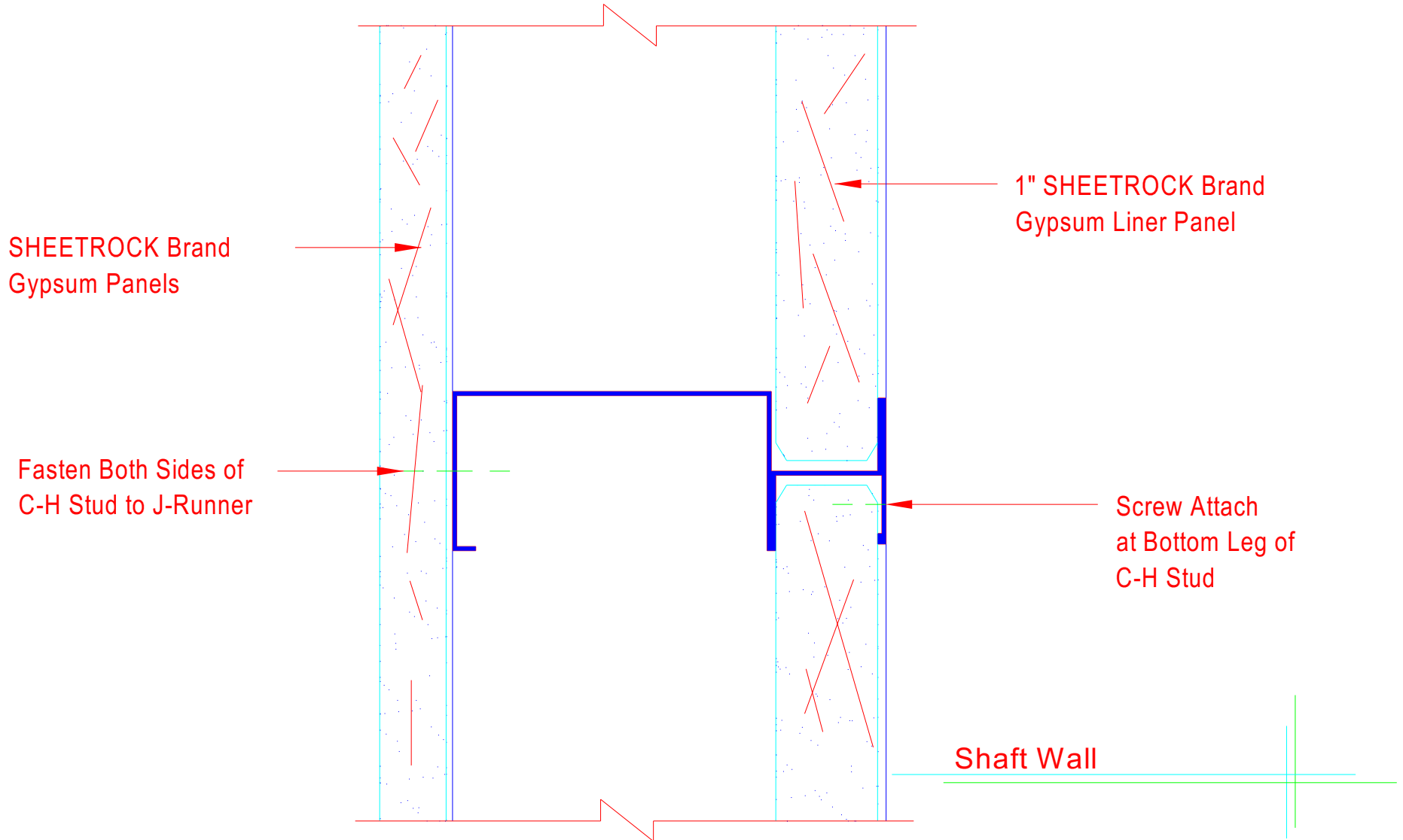

USG Corporation  
125 South Franklin Street  
Chicago, IL 60606-4678

Architectural and Technical Solutions  
800-874-4968

Drawn by: N/A  
Approved: SM  
Revision: DN  
Scale: Not to Scale

Date: August 18, 2006  
Date:  
Change:  
Project:  
File: 093100043

SHEETROCK Brand  
Gypsum Panels

Fasten Both Sides of  
C-H Stud to J-Runner

1" SHEETROCK Brand  
Gypsum Liner Panel

Screw Attach  
at Bottom Leg of  
C-H Stud

