



**FIBEROCK®**  
**Tile Backerboard**

**AQUA™  
TOUGH**



## **Tough To The Core.™**

FIBEROCK® AQUA-TOUGH™ Tile Backerboard is a unique fiber-reinforced panel for use in residential construction where moisture resistance is required.



### **Water, Mould and Moisture Resistant**

The AQUA-TOUGH™ technology provides superior water, mould and moisture resistance throughout the panel. Intended for use in intermittently wet areas including tub surrounds.



### **Finishing Flexibility**

Panels can be finished with ceramic tiles or painted like a regular gypsum panel. Available in 1/2", 3' x 5'.



### **Superior Strength**

Offers excellent resistance to abrasion, indentation and penetration. Outperforms paper-faced or glass mat faced finish.



### **Environmentally Friendly**

Panels have a certified 95% recycled content.



### **20 Warranty**

20-year comprehensive transferable warranty.

For detailed instructions on installation, please see over.



# FIBEROCK® Tile Backerboard



## TOOLS AND MATERIALS

Dust mask, T-Square, Mortar, Hammer, Nails and screws, Tape measure, Utility knife or power saw, Wide-blade taping knife (100-150 mm [4"-6"]) or trowel

## INSTALLATION

### Cutting Tile Backerboard

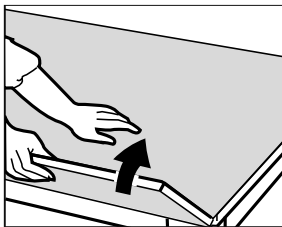
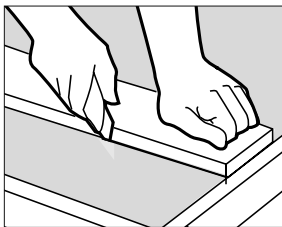

For most cuts, use "score and snap" method. Score one side of panel twice with utility knife, then snap upward along score line. Smooth rough edges with rasp.

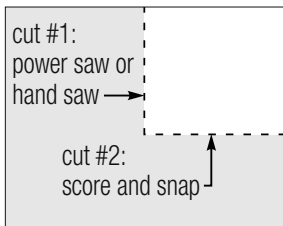

For more difficult cuts, combine "score and snap" method with use of a handsaw or low-RPM power saw.

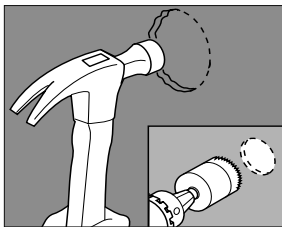

To cut holes in panels (for plumbing, etc.) use a holesaw, keyhole saw, or variable-speed jigsaw.

A power saw should be used only if equipped with a dust-collection device. Always wear a dust mask when cutting FIBEROCK® panels with a power saw.

### Positioning Panels

Install panels vertically or horizontally. Position panel ends or edges over framing members. End joints should be loosely fit. Install panels a minimum of 10 mm (3/8") above the floor or 6 mm (1/4") above tub or shower pan.

### Attaching Panels



Attach panels to framing supports by spacing fasteners not less than 10 mm (3/8") from edges and ends of panels.

Drive fastener at least every 200 mm (8") around the perimeter of the panel and along all supporting studs. Drive fasteners in field of panels first, working toward ends and edges. Fastener must be long enough to penetrate 19 mm (3/4") into wood framing.

**Wood framing.** Use corrosion-resistant Type W bugle-head screws or hot-dipped galvanized roofing nails.

**Steel Framing.** Use corrosion-resistant Type S-12 bugle-head screws for 25-12 ga. steel framing.

### Finishing Panel Joints

1. Sand uneven panel joints.
2. Prefill all joints:

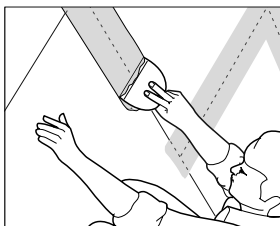

**For tiled areas,** use tile-setting mortar or adhesive, then immediately embed DUROCK® Next Gen Tape over joints. Strike joints flush.

**For untiled areas,** use CGC DURABOND® Setting-Type Joint Compound, then immediately embed CGC/Synko® Drywall paper tape. Skim over joints with a joint knife, leaving a thin coating of joint compound over all joints and interior angles. Complete to level of finish specified in project requirements.

3. When joints are completely dry, brush away all debris from panel surfaces.

### LIMITATION AND RECOMMENDATION

Do not use in areas subject to prolonged exposure to standing water, or high temperatures – for instance, in gang showers or saunas.

### Storage and Handling

1. Protect panels from the elements with adequate covering during delivery and storage.
2. Store panels flat on an even, dry surface. Allow them to acclimate to job site conditions prior to installation.
3. Handle panels in an upright position to prevent breakage.

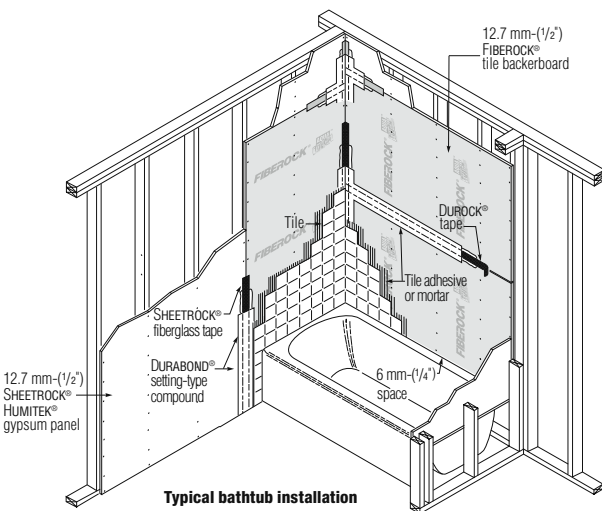

**CGC Inc.**  
350 Burnhamthorpe Rd. W, 5th Floor  
Mississauga, ON L5B 3J1  
www.cgcinc.com

FBTB\_RTL001E/3-10  
©2010, CGC Inc.  
Printed in Canada-MS