

Donn® Suspension Systems

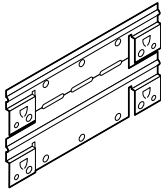

SB2 Adjustable Wall Molding Bracket

Description



The SB2 adjustable wall molding bracket is a convenient way to secure standard wall molding at an angle to accommodate a sloped acoustical ceiling.

The brackets can be field modified to accommodate numerous slopes while utilizing standard wall molding. The SB2 adjustable wall molding bracket eliminates the need for fabricated wall molding and facilitates the use of the USG ACM7 seismic clip in sloped applications. Seismically tested and listed in PEI Evaluation Report, PER-12059.

Applications

- All interior general use areas
- With intermediate and heavy-duty Donn suspension systems, AX, DX®/DXL™, FINELINE® (DXF), FINELINE® 1/8 (DXFF), CENTRICITEE™ (DXT), DXI IDENTITEE™ (DXI™), DXSS, DXW, DXLA™, and ZXLA™ (Environmental). Donn ACM7 seismic clip solutions include the code-compliant heavy-duty and intermediate duty main tee required for Seismic Design Categories A-F.

Construction

SB2 Adjustable Wall Molding Bracket

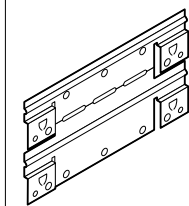

Attachment to Wall

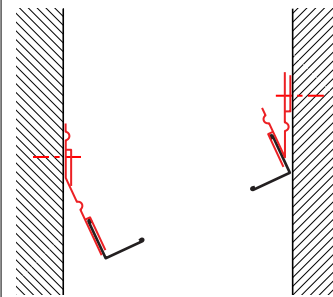

Up slope

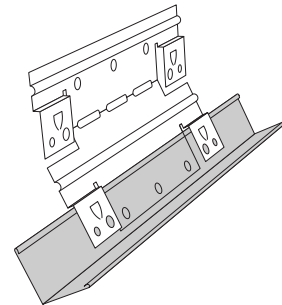
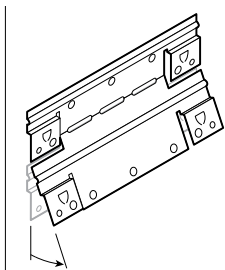

Down slope

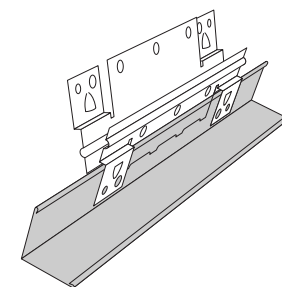
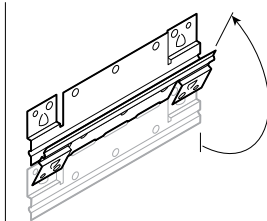

Perimeter Treatment¹

Lay-in Suspended Ceiling Slope	Non-Seismic Installation	Seismic Design Category C	Seismic Design Category D, E, F
< 15°	USG M7 wall molding with positive attachment on all tee ends or 7/8-in. fabricated / locally sourced wall molding with positive attachment on all tee ends	USG M7 wall molding with ACM7 seismic clip or 7/8-in. fabricated / locally sourced wall molding with ACM7 seismic clip	USG M7 wall molding with ACM7 seismic clip or 7/8-in. fabricated / locally sourced wall molding with ACM7 seismic clip
15° – 25°	SB2 adjustable wall molding bracket with positive attachment on all tee ends or 7/8-in. fabricated / locally sourced wall molding with positive attachment on all tee ends	SB2 adjustable wall molding bracket installed with USG M7 wall molding and the USG ACM7 seismic clip	SB2 adjustable wall molding bracket installed with USG M7 wall molding and the USG ACM7 seismic clip
> 25°	Fabricated / locally sourced wall molding with positive attachment on all tee ends	Engineered	Engineered

¹ Please refer to Seismic Technical Guide, Sloped Ceilings (SC2508) for more information.

Submittal Approvals

Job Name	
Contractor	Date

Physical Data/ Footnotes

<p>Material Hot-dipped galvanized steel.</p> <p>Recycled Content 25%. For details, see the Sustainability selector.</p> <p>Installation Must be installed in compliance with ASTM C636, ASTM E580, Cisca, and standard industry practices.</p> <p>CAUTION Avoid bending the bracket back and forth too many times which will cause metal fatigue and weaken the bracket.</p>	<p>Limitations The performance of the SB2 adjustable wall molding bracket and systems is based on the specific combination of superior components, and design and installation methods shown. Components from other manufacturers were not evaluated, and their use or any mixed use is not recommended.</p> <p>ICC Evaluation Service, Inc., Report Compliance Suspension systems manufactured by USG Interiors, LLC, have been reviewed and are approved by listing in ICC-ES Evaluation Report 1222. Evaluation Reports are subject to reexamination, revision and possible cancellation. Please refer to usgdesignstudio.com or 800.USG.4YOU for current reports.</p>	<p>L.A. Research Report Compliance Down brand suspension systems manufactured by USG Interiors, LLC, have been reviewed and are approved by listing in the following L.A. Research Report number: 25764.</p> <p>Progressive Engineering Inc. Evaluation Report Compliance Seismically tested and listed in PEI Evaluation Report, PER-12059.</p> <p>Code Compliance The information presented is correct to the best of our knowledge at the date of issuance. Because codes continue to evolve, check with a local official prior to designing and installing a ceiling system. Other restrictions and exemptions may apply.</p>	<p>Notice We shall not be liable for incidental and consequential damages, directly or indirectly sustained, nor for any loss caused by application of these goods not in accordance with current printed instructions or for other than the intended use. Our liability is expressly limited to replacement of defective goods. Any claim shall be deemed waived unless made in writing to us within thirty (30) days from date it was or reasonably should have been discovered.</p>	<p>Construction Details Please see AC2508 for construction details.</p> <p>Safety First! Follow good safety/industrial hygiene practices during installation. Wear appropriate personal protective equipment. Read MSDS and literature before specification and installation.</p>
--	---	--	---	---

